

# TYPE LA200S

## Dimensioner

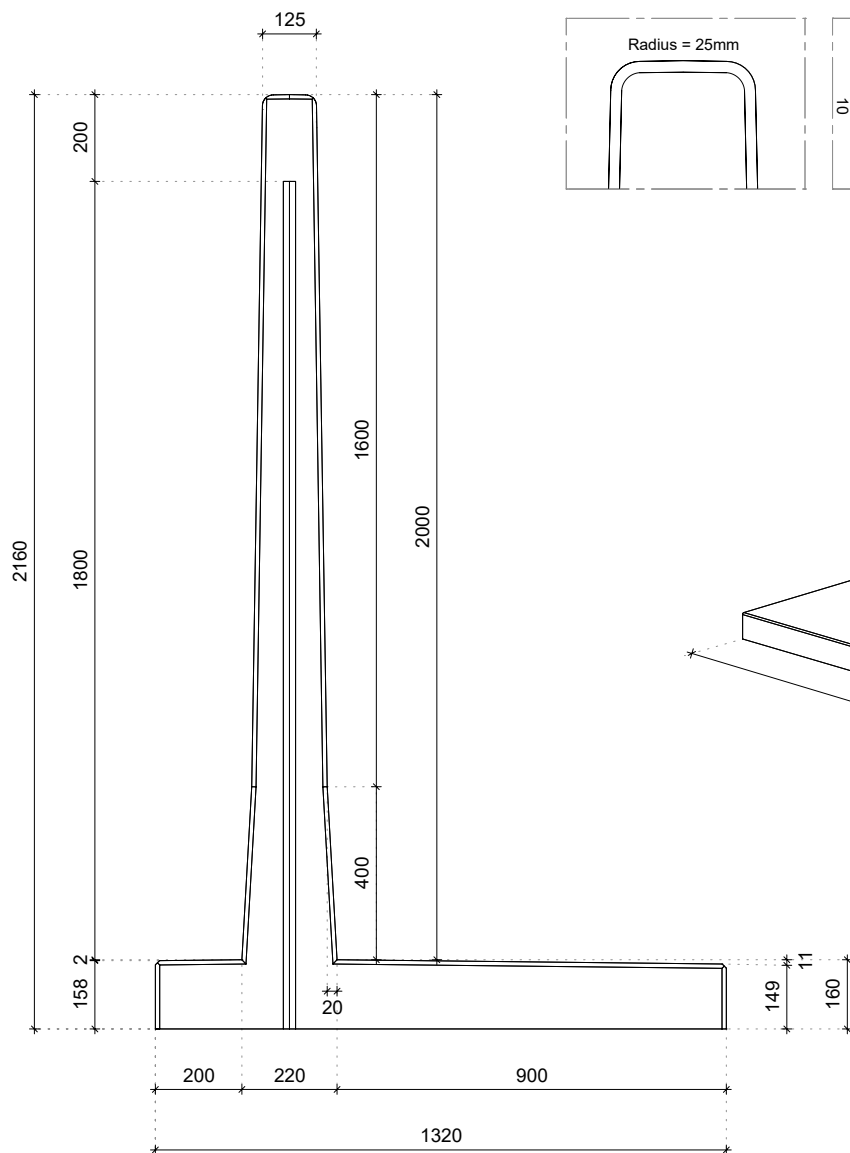

## Detaljer

Afrundet top

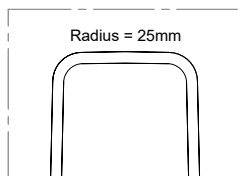

Udskæring til samlings liste

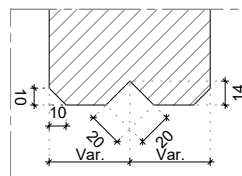

Element samling

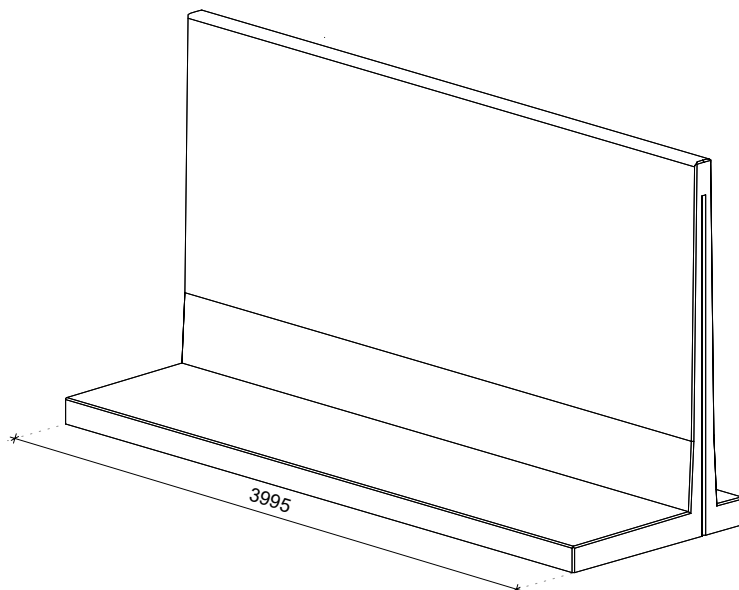
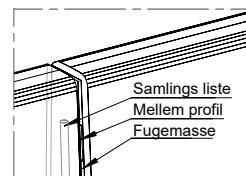

## Tekniske detaljer

|                       |                                       |
|-----------------------|---------------------------------------|
| Betonblanding         | 2nd Generation self-compacting C60/75 |
| Armering af stål      | B500                                  |
| Vægt                  | 4975kg (L = 3995mm)                   |
| Betondækning          | 30mm                                  |
| Dimensionel tolerance | +/- 5mm                               |
| Synlig betonklasse    | Alle synlighed sider klasse A         |
| Design liv            | 50 år                                 |
| Produktgaranti        | 10 år                                 |
| Miljøklasse           | XA3, XC4, XD3, XS3, XF4               |
| Hejseanordning        | ingen, steder med klemme              |

## Konstrueret i overensstemmelse med

|                       |                       |
|-----------------------|-----------------------|
| DS-EN 1990 Eurocode 0 | DS-EN 206             |
| DS-EN 1991 Eurocode 1 | Incl. nationale bilag |
| DS-EN 1992 Eurocode 2 |                       |
| DS-EN 1997 Eurocode 7 |                       |

## Produktionsmetode



Energi  
neutral



Filterret  
regnvand



Bæredygtige  
råvarer



Genanvendelige  
materialer

## Certifier

